

South Carolina

Greenville District

74

Pursuant to a warrant from Wm D Thomas, Com. Loc. for District, I have admeasured & laid out unto James Pollard a tract of land containing one hundred & eighty seven acres, in the district & state aforesaid.

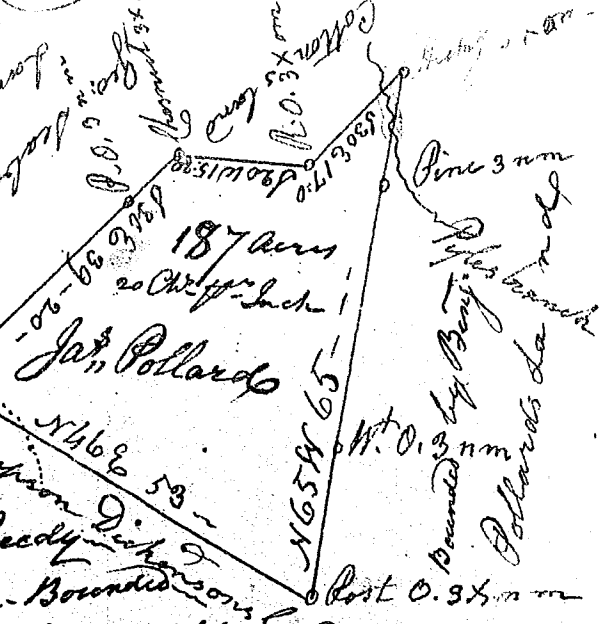

On Pyles Branch of Reedy River. Bounded N, E, & W by Benj. Pollard's land, N, W, by Cottons lands W. & S. W. by George Seaborn's land, and S E by Thompson Dickerson's land, & has such form & mark, as the above plat represents.

Surveyed this 16th April 1813 by me B. Griffith D.D. Warrant dated 15 April 1813. Recorded the 19th April 1813 - Det. Self

South Carolina

Pursuant to a Warrant from Wm D Thomas, Com. Loc. in the District of Greenville, dated the 19th March 1813. I have admeasured & laid out unto Willson Cobb, a tract of land containing one hundred and thirty acres, situate in said District.

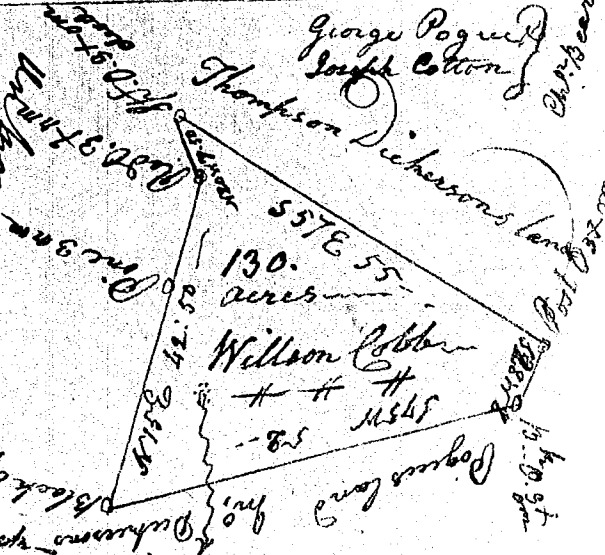

on the branches of Bakers creek, waters of Reedy fork of Reedy River, Bounded by a line N. E. by Thompson Dickerson's land S. W. by Pogues & John Dickerson's all other sides with such form & marks as the above plat represents. Surveyed the 19th March 1813.

Recorded 22nd May 1813 - Micajah Berry D.S.